

**Three Days Total Station Survey Camp**  
during  
31.01.2019 to 03.04.2019

**Department of Civil Engineering**  
**SCMS School of Engineering & Technology**

The Department of Civil Engineering had conducted a 3 day training program during the period 31.01.2019 to 03.04.2019 in various batches for the students of Semesters VI (2016-20Batch) and VIII (2015-19 Batch) with objective of imparting adequate working knowledge on survey using total station, data transfer and interpretation.

The days were divided into 6 sessions. The morning session of the first day constituted of a lecture for the students on how to use the instrument and its various applications. During the second session the students were tasked to do reconnaissance survey of an area. During this session they had roughly fixed the instrument stations and number of stations to be surveyed.

On the second day, morning session constituted of a hands on training with the instrument and during the afternoon session students were given the instruments, they set out in the field. The surveying continued to the next day. During the afternoon session of the last day, the students transferred the surveyed data to a PC and the completed the drawing in AutoCAD.

The team of faculty included

**Mr. Sandeep T N**, Ms. Anitha Jacob, Mr. Deeraj D

**Mr. Jerry Anto**, Ms. Tenu Syriac, Mr. Anvin Sebastian

**Sessions:**

Sl. No.	Session	Description
1	Day 1	<ol style="list-style-type: none"> <li>1. Introduction to use the Instrument.</li> <li>2. Verification with a known area of plot.</li> <li>3. Reconnaissance survey (fixing of station points – O1,O2,O3... and survey points – P1, P2, P3.....).</li> </ol>
2	Day 2	<ol style="list-style-type: none"> <li>1. Preparation of rough layout manually including marking of points O1, P1 etc in A3 size paper.</li> <li>2. Surveying the given area using total station.</li> </ol>
3	Day 3	<ol style="list-style-type: none"> <li>1. Surveying continued.</li> <li>2. Transferring of data into PC</li> <li>3. Preparation of layout in CAD, PDF format and hard copy formats (A3 size).</li> </ol>

**Time Table:**

Sl. No.	Date and Time	Class and Roll no of Students
1	31.01.19, 01.02.19, 02.02.19	S6S6CE1: 1 to 10 (Group 1) S6S6CE1: 11 to 20 (Group 2) S6S6CE1: 21 to 30 (Group 3)
2	05.02.19, 06.02.19, 07.02.19	S6S6CE2: 1 to 9 (Group 4) S6S6CE2: 10 to 18 (Group 5) S6S6CE2: 19 to 27 (Group 6)
3	14.02.19, 15.02.19, 16.02.19	S6S6CE1: 31 to 40 (Group 7) S6S6CE1: 41 to 50 (Group 8) S6S6CE1: 51 to 59 (Group 9)
4	19.02.19, 20.02.19, 21.02.19	S6S6CE2: 28 to 37 (Group 10) S6S6CE2: 39 to 47 (Group 11) S6S6CE2: 48 to 55 (Group 12)
5	02/04/19, 03/04/19	S8CE (Group 13)

The key plan of the area being surveyed is given below.

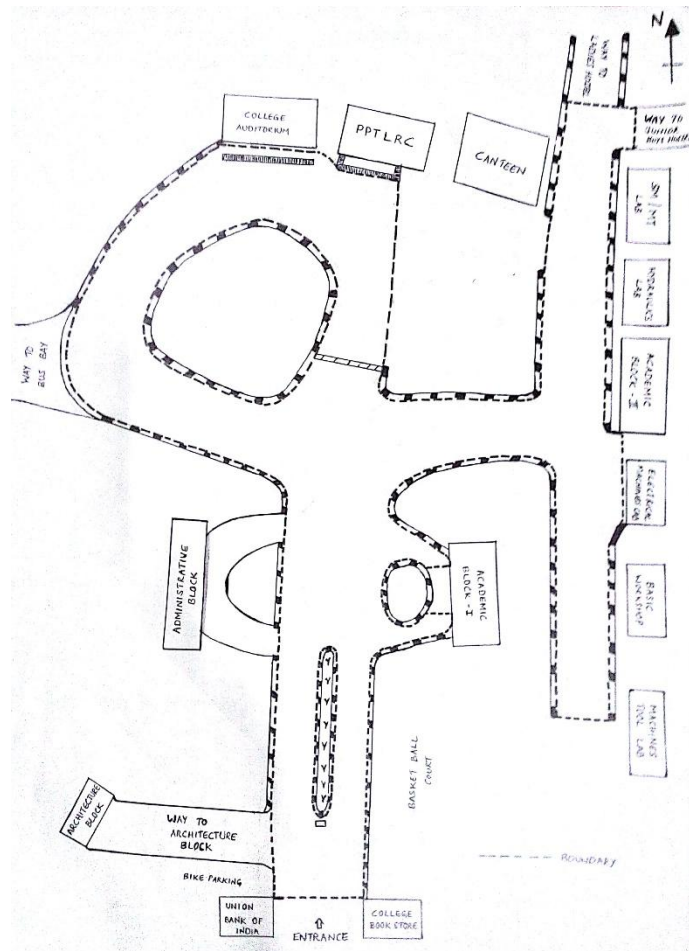

Part plan of the out from the camp is given below

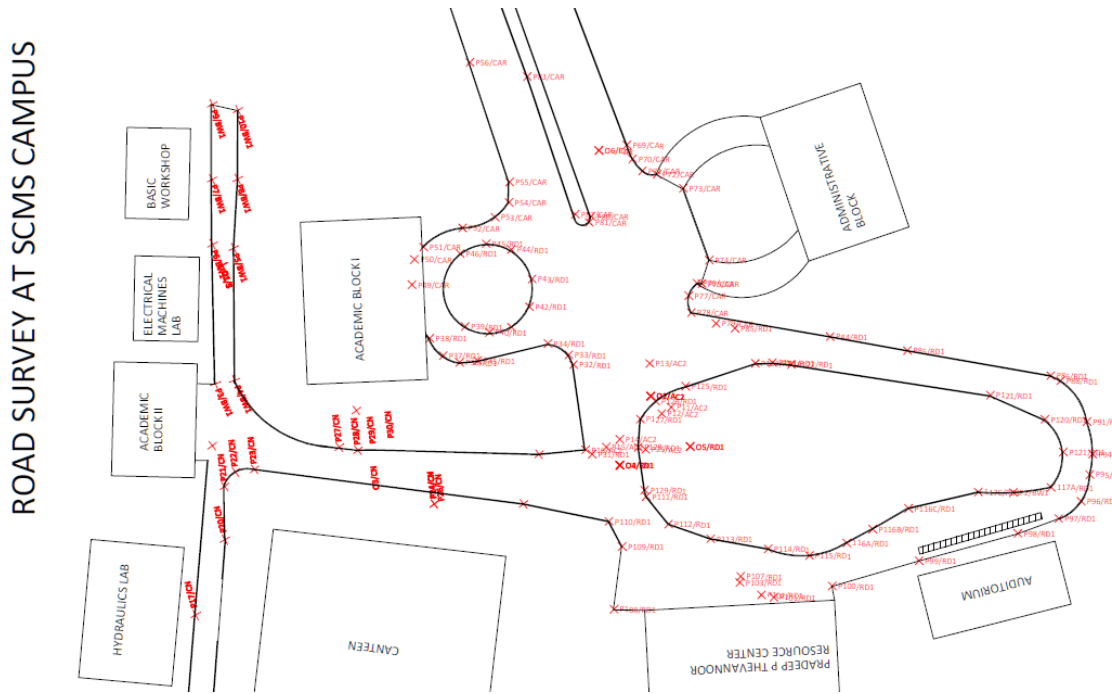

Few photographs of the training session is given below.



